

North Liberty Parks & Recreation Committee Meeting
Thursday, March 1, 2018
Proposal of Agenda
7:00PM

NEW BUSINESS:

1. Approve minutes from meeting of: Minutes from January meeting.
No minutes from February, no quorum.
2. Public Comments/Concerns: Open to public for comments and concerns; 5 minutes per person time limit.
3. Park Board Vacancy: I have heard we have received applications, appointment by Mayor at one of March's city council meetings. New person on board in April.
4. Centennial Park:
 - a) Rock climbing feature options
 - b) Centennial Park; CIP = \$350,000; prioritize amenities.
5. Fees / Membership Discussion: Discussion continues on new fee / membership proposal, changes to simplify options and increase fees with future implementation.
6. Building & Grounds Report: Parks Monthly Report
7. Baseball/Softball Update: Babe Ruth Field Update
Brian had (38) competitive teams at Field Lottery, Wed.
8. Upcoming Events: Easter Egg Hunt March 24
9. Any new issues not on the agenda?

OLD BUSINESS:

1. Recreation Monthly Report: Report included in packet summarizing the past month.
2. Any old business not on agenda? Joint Meeting with Council to be determined.

CONCLUSION:

1. Next Meeting: Thursday, April 5, 2018 at 7:00 PM
Location: City Council Chambers at 1 Quail Creek Circle
2. Adjourn



ID SCULPTURE

PLAY. CLIMB. EXPLORE.

Quote

Project Name: North Liberty_Centennial Park

Attn: Guy Goldsmith_City of North Liberty, IA

Date of Quote 1/22/2018

Description:

Glass Fiber Reinforced Concrete (GFRC) playground sculptures.

- This quote includes:
 - Shipping
 - Construction documentation.
- This quote does not include:
 - Installation
 - The required footings. Please refer to manufacturer's specifications.

Equipment and Services

Item	Part #	Description	Quantity	Unit Cost	Total Price
Moab Arch	CB017	16'-10"x5'-6"x8'-8"	1	\$25,500.00	\$ 25,500.00
Mesa Verde	CMB003	26'-8"x11'-9"x5'-10"	1	\$28,000.00	\$ 28,000.00
Erosion boulder	CB004	8'-7"x12'-5"x8'-0"	1	\$24,000.00	\$ 24,000.00
Palisades Boulder	CB001	13'-0"x6'-6"x8'-2"	1	\$19,500.00	\$ 19,500.00
Linkin' Log	AP031	7'-2"x3'-0"x2'-4"	1	\$4,000.00	\$ 4,000.00
Stepping Form-SM	SF002-SM	10" DIA	1	\$400.00	\$ 400.00
Stepping Form-MD	SF002-MD	18" DIA	1	\$600.00	\$ 600.00
Stepping Form-LG	SF002-LG	28" DIA	1	\$800.00	\$ 800.00
Walking Tree	CUS001	8'-0"x1'-3"x2'-4"	1	\$4,000.00	\$ 4,000.00

Additional Features, Equipment and Services Subtotal \$ 106,800.00

Summary

Custom Products		\$ -
Additional Products, Services and Equipment		\$ 106,800.00
Shipping and Handling <i>North Liberty, IA 52317</i>		\$ 4,800.00
Sales tax <i>tax exempt institution- please verify</i>	0.0%	\$ -
MSRP		\$ 111,600.00



IDS SCULPTURE

PLAY. CLIMB. EXPLORE.

Terms and Conditions

All design and construction work to be governed by AIA Subcontract, IDS Service Agreement or purchase order.

Purchase orders should reflect the manufacturers suggested retail price and dealer discount. 50% deposit due with purchase order or executed sales agreement, 50% due FOB, Net 30. If IDS is required to store product for more than 10 weeks beyond the original ship date a final invoice will be issued, less shipping cost.

This estimate does not constitute an agreement for goods or services on behalf of Integrated Design Solutions

An additional fee of 3% of the total contract price will be incurred by Owner should IDS be required to enter into different or additional contracts with owner or agents of the owner.

Once your estimate is approved, it will be included in the IDS's standard service agreement and contingent upon the execution of that agreement.

Estimated Prices are valid for 90 days from date of estimate listed above

Estimated cost and completion date does not account for any necessary local code review, permitting, or inspections of the substructure or climbing facade. Additional costs and time delays will be the responsibility of the Owner.

Total price does not include bonds, licenses, training, **prevailing wage** and/or union labor rates or permit and/or inspection costs, or on site power, water, waste disposal, or toilet facilities.

Estimate assumes that IDS will be given firm dates for a construction window at least 3 months before commencement of construction. Owner to be responsible for demobilization and remobilization expenses if the construction window should change with less than 1 month notice.

Please authorize this order by signing and returning by email to your salesperson in lieu of a "Purchase Order"

Signature _____ **Date** _____

Name _____

Title _____



1 Perspective

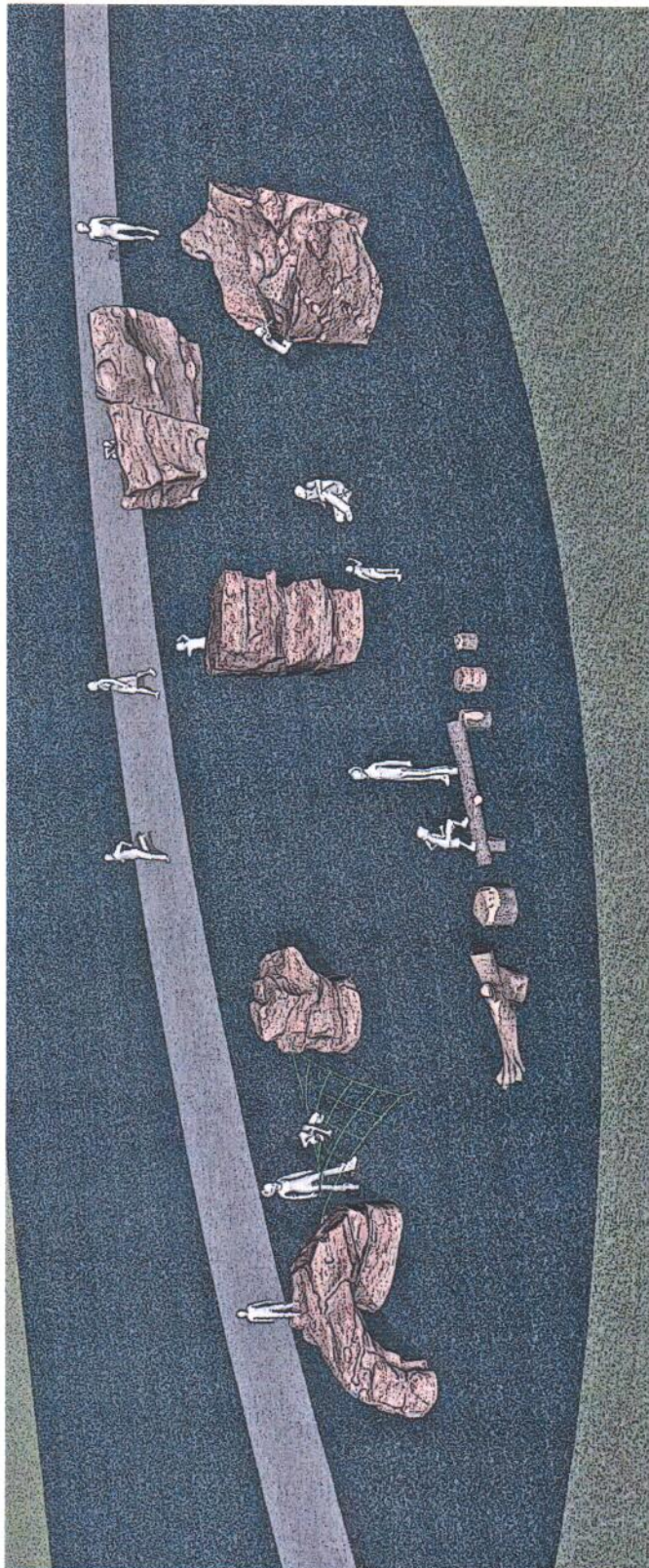

2 Perspective

All IDS projects are designed to meet or exceed ASTM 1487.
 Not all equipment may be appropriate for all children.
 Supervision is required.
 ASTM compliant safety surfacing is required under and around all play equipment.
 The Americans with Disabilities Act (ADA) may require your play area to be accessible, please consult with an ADA professional to ensure compliance.

Date
1/22/2018

Drawing Title
Perspectives V1

Sheet #
A.01.1

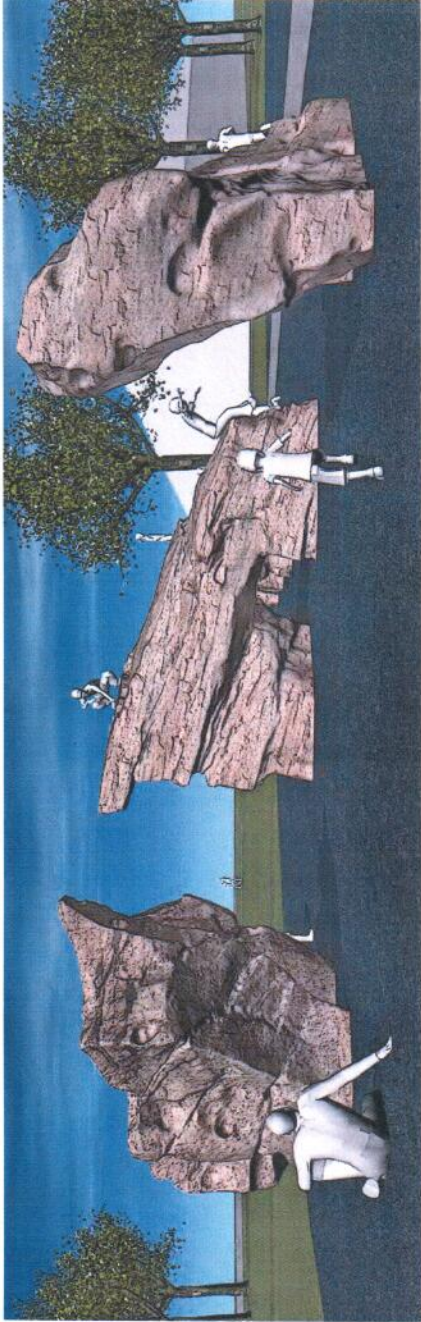

3 Perspective

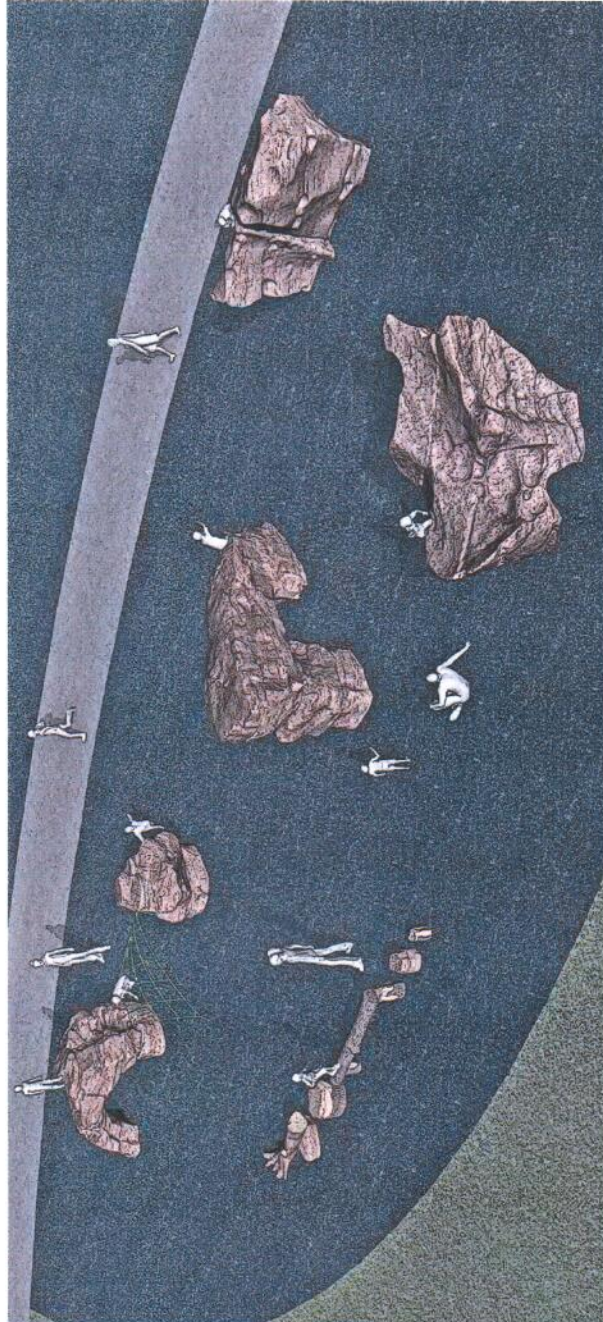

4 Perspective

All IDS projects are designed to meet or exceed ASTM 1487.

Not all equipment may be appropriate for all children.

Supervision is required.

ASTM compliant safety surfacing is required under and around all play equipment.

The Americans with Disabilities Act (ADA) may require your play area to be accessible; please consult with an ADA professional to ensure compliance.

Date

1/22/2018

Drawing Title

Perspective V1

Sheet #

A.01.2

All IDS projects are designed to meet or exceed ASTM 1487. Not all equipment may be appropriate for all children. Supervision is required. ASTM compliant safety surfacing is required under and around all play equipment. The Americans with Disabilities Act (ADA) may require your play area to be accessible, please consult with an ADA professional to ensure compliance.

Date	1/22/2018
Drawing Title	Layout V1
Sheet #	A.01.5

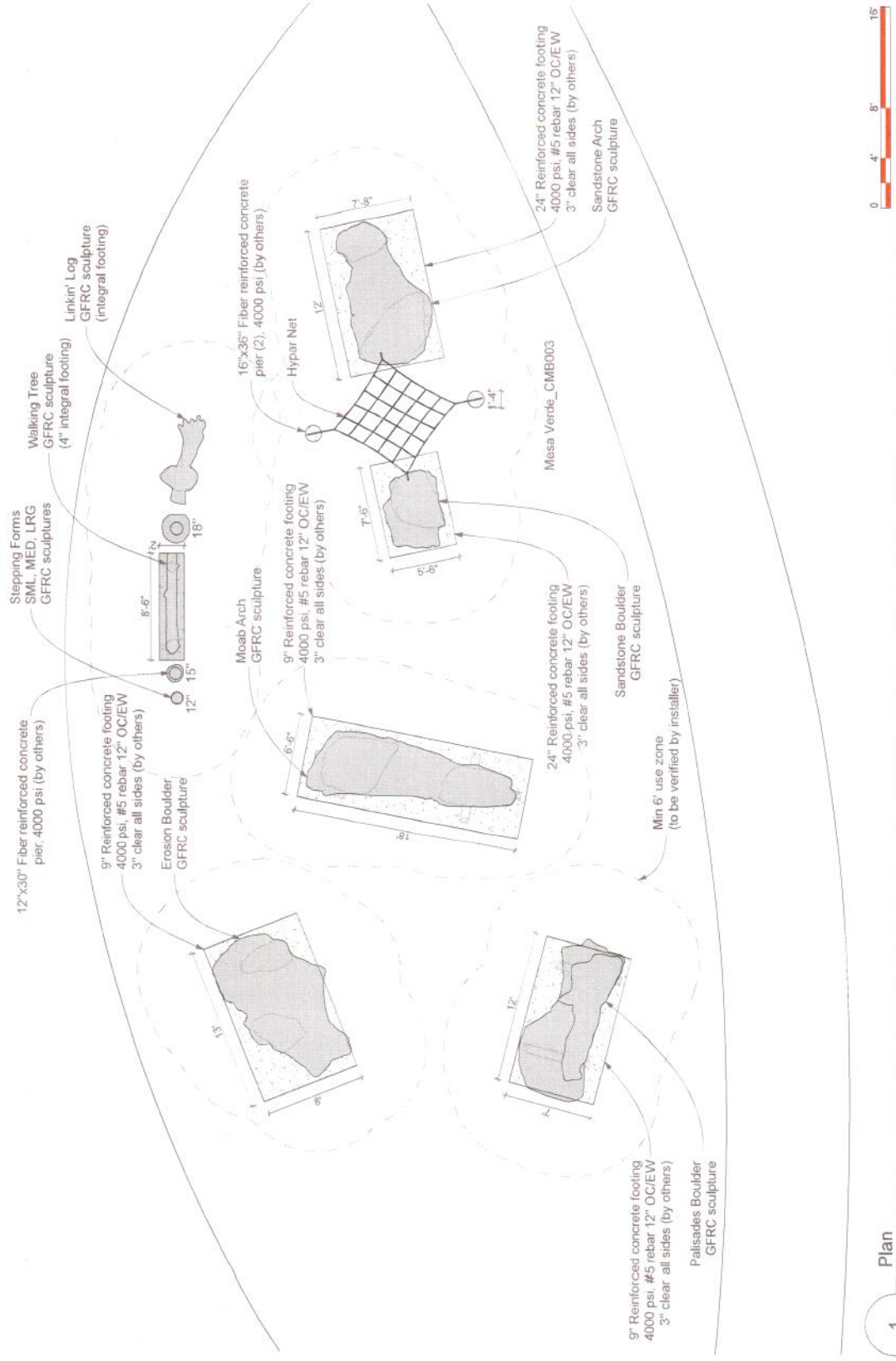

1 SCALE: 1/8" = 1'-0"

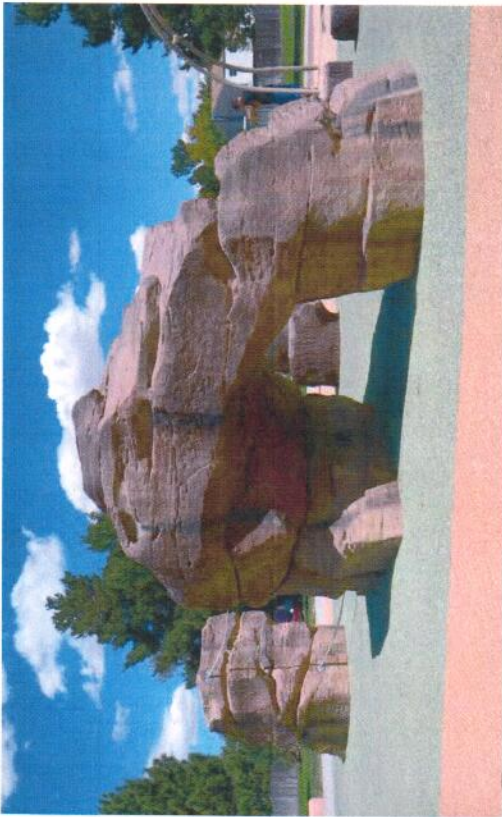

1 Rocks and Rope Combo

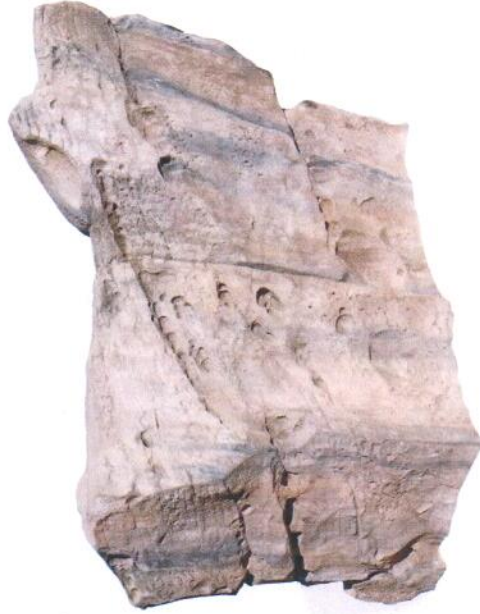

2 Palisades Boulder_CB001



3 Moab Arch_CB017



4 Stepping Forms_SF002

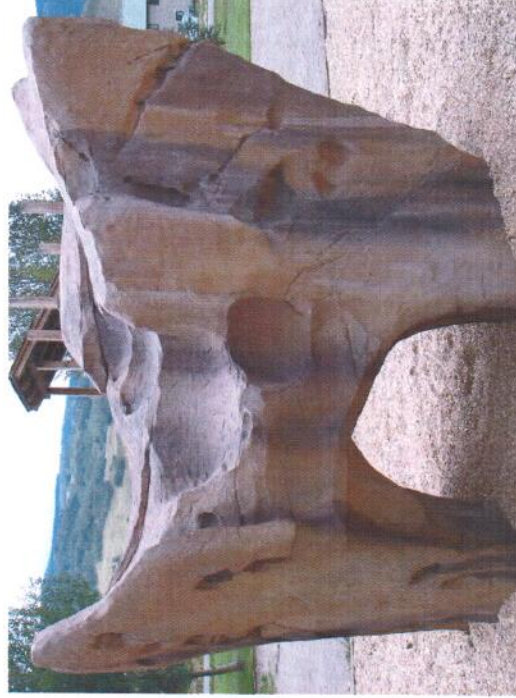

5 Erosion Boulder_CB004



IDS SCULPTURE
PLAY. CLIMB. EXPLORE.

Centennial Park
North Liberty, IA 52317

SCHEMATIC DESIGN
NOT FOR CONSTRUCTION

All IDS projects are designed to meet or exceed ASTM 1487.

Not all equipment may be appropriate for all children.

Supervision is required.

ASTM compliant safety surfacing is required under and around all play equipment.

The Americans with Disabilities Act (ADA) may require your play area to be accessible, please consult with an ADA professional to ensure compliance.

Date

1/22/2018

Drawing Title

Design Reference V1

Sheet #

A.01.7

IDS 591 South Boulevard Street
Gunnison, Colorado 81230
info@idsculpture.com

2/1/2018

FY1819 proposed Centennial Park Budget

Proposed FY1819 Budget \$350,000.00

Amphitheater Engineering Design \$75,000.00

Amphitheater Fund Raising Consultant \$50,000.00

\$225,000.00 remaining to allocate to other projects listed below.

Additional project to consider

- Splash Pad (5000 sq. ft.) \$375,000.00 (Additional cost for utilities)
- Park open shelter by west parking lot \$100,000.00
- Additional rock climbing features to complete the rock climbing area \$102,000.00
- Trail connection for rock climbing area and shelter to the west parking lot \$50,000.00
- Trail connection for tot lot & rock climbing features \$40,000.00
- Tot lot playground \$55,000.00

Options to Consider

Splash pad- Over budget

Option 1: Additional rock climbing features to complete rock climbing area \$101,600.00
(\$30,000.00 Meet me at the Park Spaces Grant has been applied for).

Safety surface for rock climbing area \$20,000.00

Tot lot playground \$55,000.00

Trail connection for tot lot & rock climbing features \$40,000.00 (\$10,000 of this for
Concrete footings for rock climbing area)

Total: \$216,600.00 (\$8400.00 under budget)

Option 2: Tot lot \$55,000.00

Shelter \$100,000.00

Trail connection for shelter & tot lot \$25,000.00

Total: \$180,000.00 (\$45,000.00 under budget)

Option 3: Make splash pad small to fit budget. 2500 sq. ft. (Utilities need to be a factor also)
For comparison Penn Meadows Splash pad is 1661 sq. ft.



ID SCULPTURE

PLAY. CLIMB. EXPLORE.

Quote

Project Name: North Liberty_Centennial Park

Attn: Guy Goldsmith_City of North Liberty

Date of Quote 2/2/2018

Description:

Glass Fiber Reinforced Concrete (GFRC) playground sculptures.

- This quote includes:
 - Shipping
 - Construction documentation.
- This quote does not include:
 - Installation
 - The required footings. Please refer to manufacturer's specifications.

Equipment and Services

Item	Part #	Description	Quantity	Unit Cost	Total Price
Mesa Verde	CMB003	26'-8"x11'-9"x5'-10"	1	\$28,000.00	\$ 28,000.00
Pagosa Boulder	PB006	12'-3"x7'-9"x10'-0"	1	\$29,000.00	\$ 29,000.00
Moab Arch	CB017	16'-10"x5'-6"x8'-8"	1	\$25,000.00	\$ 25,000.00
The Mighty Fin	PB004	14'-2"x2'-10"x9'-2"	1	\$16,000.00	\$ 16,000.00
Erosion boulder	CB004	8'-7"x12'-5"x8'-0"	1	\$24,000.00	\$ 24,000.00
Palisades Boulder	CB001	13'-0"x6'-6"x8'-2"	1	\$19,500.00	\$ 19,500.00
Charlotte's Web	AP005	8'-0"x7'-11"x4'-7"	1	\$14,900.00	\$ 14,900.00
Log Balance Course	AP015	19'-8"x6'-2"x3'-7"	1	\$12,000.00	\$ 12,000.00
Plyo Stump	AP014	8'-9"x2'-0"x3'-1"	1	\$5,700.00	\$ 5,700.00
Staggered Stumps	AP020	6'-10"x3'-2"x3'-1"	1	\$4,600.00	\$ 4,600.00
Stepping Form-LG	SF002-LG	28" DIA	1	\$800.00	\$ 800.00
Stepping Form-MD	SF002-MD	18" DIA	2	\$600.00	\$ 1,200.00
Stepping Form-SM	SF002-SM	10" DIA	7	\$400.00	\$ 2,800.00
Washington Vine	AP023	5'-6"x8'-0"x2'-10"	1	\$5,500.00	\$ 5,500.00
Smith Vine	AP022	6'-9"x9'-7"x4'-6"	1	\$9,700.00	\$ 9,700.00
Walking Tree		8'-0"x1'-3"x2'-4"	1	\$4,000.00	\$ 4,000.00
Splitface Balance		6'-6"x5'-5"x1'-0"	1	\$3,000.00	\$ 3,000.00

Additional Features, Equipment and Services Subtotal \$ 205,700.00

total on next page.



ID SCULPTURE

PLAY. CLIMB. EXPLORE.

Summary

Additional Products, Services and Equipment			\$ 205,700.00
Shipping and Handling	<i>North Liberty, IA 52317</i>		\$ 7,500.00
Sales tax	<i>tax exempt institution- please verify</i>	0.0%	\$ -
MSRP			\$ 213,200.00



IDS SCULPTURE

PLAY. CLIMB. EXPLORE.

Terms and Conditions

All design and construction work to be governed by AIA Subcontract, IDS Service Agreement or purchase order.

Purchase orders should reflect the manufacturers suggested retail price and dealer discount. 50% deposit due with purchase order or executed sales agreement, 50% due FOB, Net 30. If IDS is required to store product for more than 10 weeks beyond the original ship date a final invoice will be issued, less shipping cost.

This estimate does not constitute an agreement for goods or services on behalf of Integrated Design Solutions

An additional fee of 3% of the total contract price will be incurred by Owner should IDS be required to enter into different or additional contracts with owner or agents of the owner.

Once your estimate is approved, it will be included in the IDS's standard service agreement and contingent upon the execution of that agreement.

Estimated Prices are valid for 90 days from date of estimate listed above

Estimated cost and completion date does not account for any necessary local code review, permitting, or inspections of the substructure or climbing facade. Additional costs and time delays will be the responsibility of the Owner.

Total price does not include bonds, licenses, training, **prevailing wage** and/or union labor rates or permit and/or inspection costs, or on site power, water, waste disposal, or toilet facilities.

Estimate assumes that IDS will be given firm dates for a construction window at least 3 months before commencement of construction. Owner to be responsible for demobilization and remobilization expenses if

Please authorize this order by signing and returning by email to your salesperson in lieu of a "Purchase Order

Signature _____ **Date** _____

Name _____

Title _____



1

Perspective

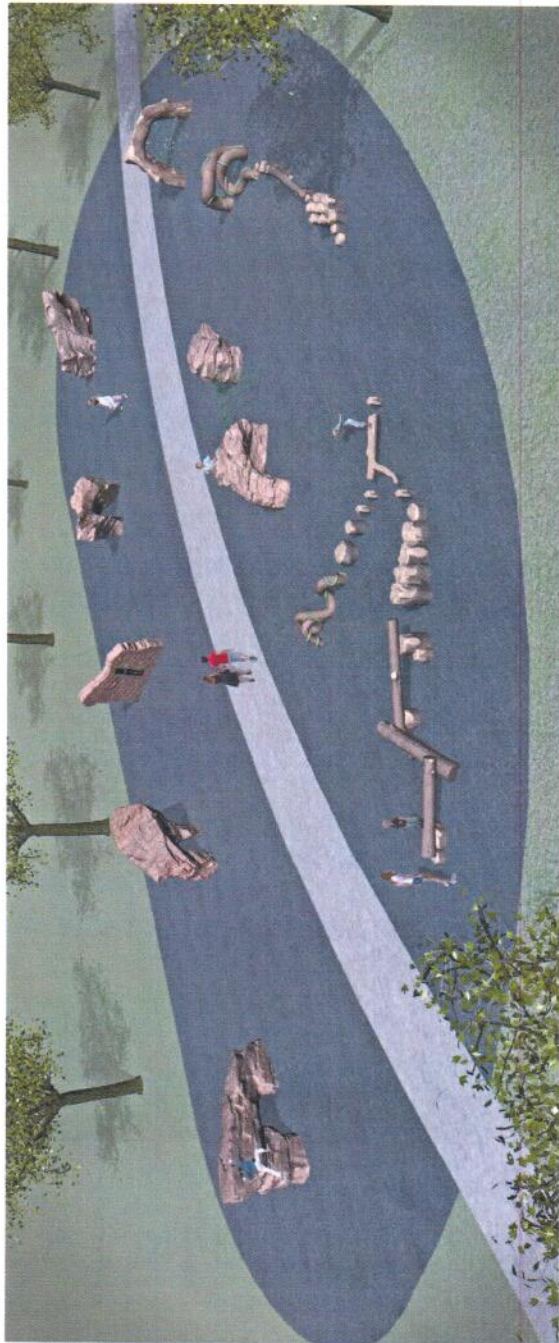

2

Perspective



Centennial Park
North Liberty, IA 52317

SCHEMATIC DESIGN
NOT FOR CONSTRUCTION

All IDS projects are designed to meet or exceed ASTM 1487. Not all equipment may be appropriate for all children. Supervision is required. ASTM compliant safety surfacing is required under and around all play equipment. The Americans with Disabilities Act (ADA) may require your play area to be accessible, please consult with an ADA professional to ensure compliance.

Date	2/2/2018
Drawing title	Perspectives
Sheet #	A.01.1



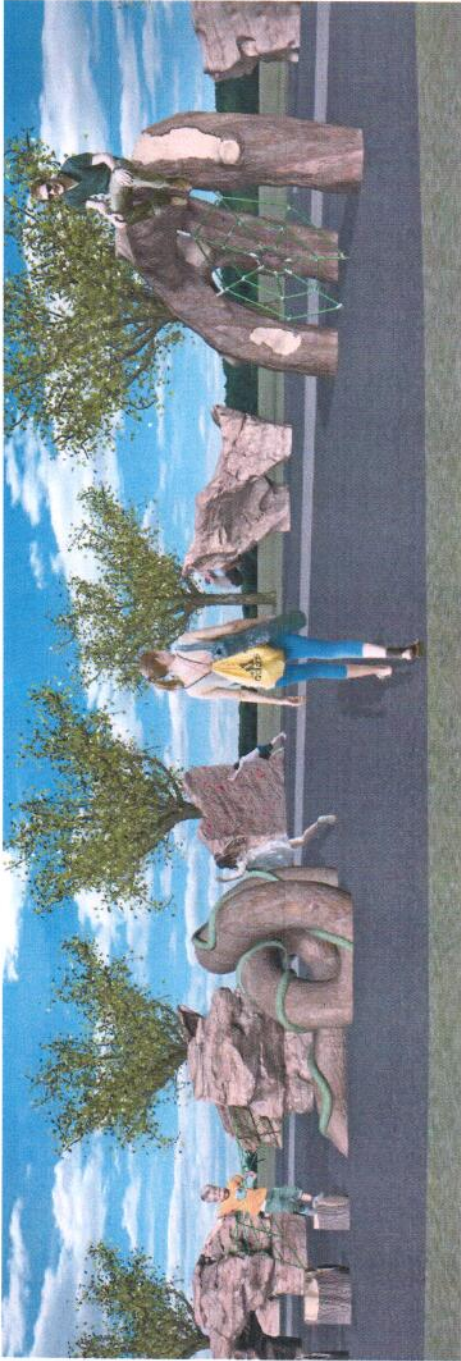

7
Perspective

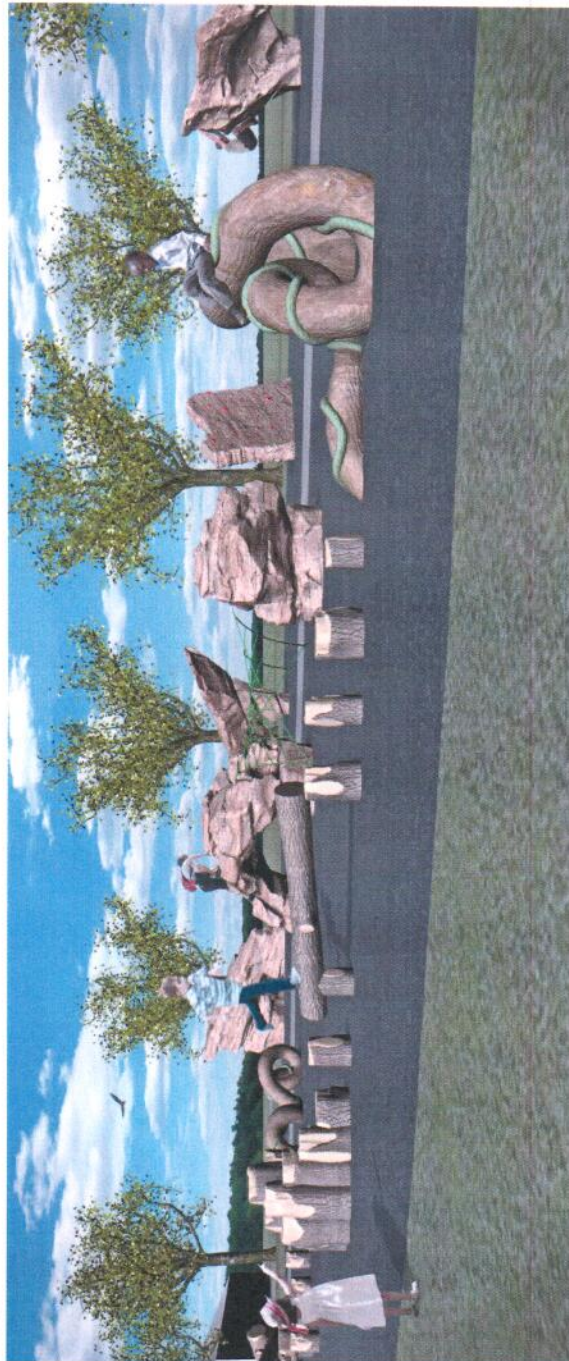

8
Perspective

All IDS projects are designed to meet or exceed ASTM 1487.
Not all equipment may be appropriate for all children. Supervision is required.
ASTM compliant safety surfacing is required under and around all play equipment.
The Americans with Disabilities Act (ADA) may require your play area to be accessible, please consult with an ADA professional to ensure compliance.

Date: 2/2/2018

Drawing Title: Perspectives

Sheet #: A.01.4



3

Perspective



4

Perspective



Centennial Park

North Liberty, IA 52317

SCHEMATIC DESIGN
NOT FOR CONSTRUCTION

All IDS projects are designed to meet or exceed ASTM 1487.

Not all equipment may be appropriate for all children.

Supervision is required.

ASTM compliant safety surfacing is required under and around all play equipment.

The Americans with Disabilities Act (ADA) may require your play area to be accessible, please consult with an ADA professional to ensure compliance.

Date

2/2/2018

Drawing Title

Perspectives

Sheet #

A.01.2



591 South Boulevard Street
Gunnison, Colorado 81230
info@idsculpture.com



5 Perspective

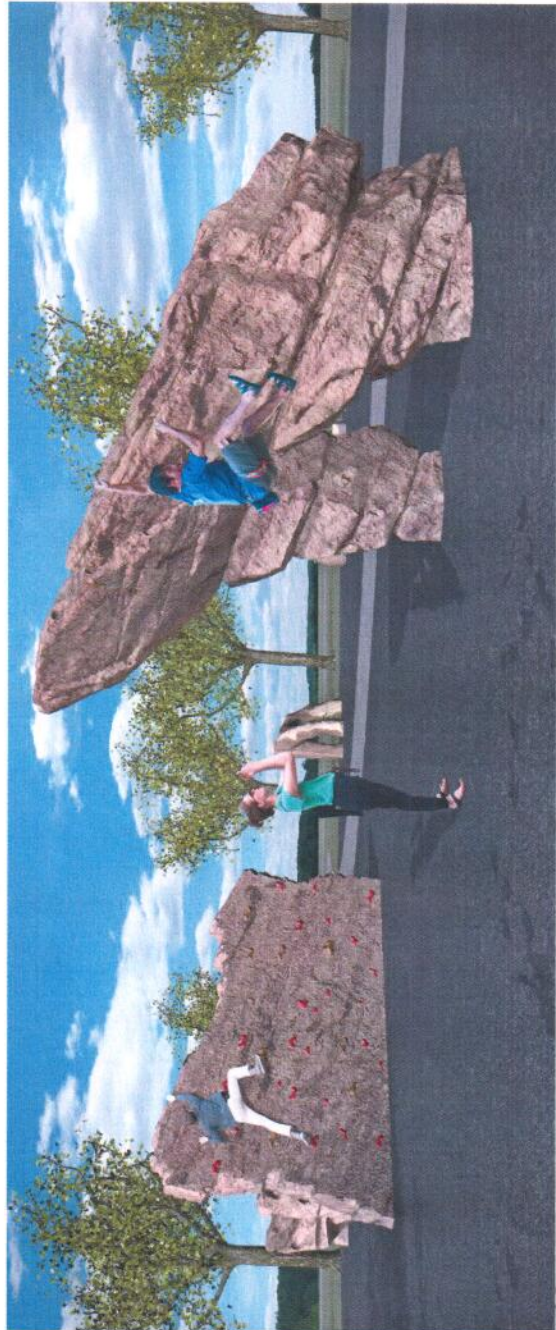

6 Perspective



Centennial Park
North Liberty, IA 52317

SCHEMATIC DESIGN
NOT FOR CONSTRUCTION

All IDS projects are designed to meet or exceed ASTM 1487.
Not all equipment may be appropriate for all children.
Supervision is required.
ASTM compliant safety surfacing is required under and around all play equipment.
The Americans with Disabilities Act (ADA) may require your play area to be accessible, please consult with an ADA professional to ensure compliance.

Date
2/2/2018

Drawing title
Perspectives

Sheet #
A.01.3



All IDS projects are designed to meet or exceed ASTM 1487. Not all equipment may be appropriate for all children. Supervision is required. ASTM compliant safety surfacing is required under and around all play equipment. The Americans with Disabilities Act (ADA) may require your play area to be accessible, please consult with an ADA professional to ensure compliance.

Date	2/2/2018
Drawing Title	Design Reference
Sheet #	A.01.6

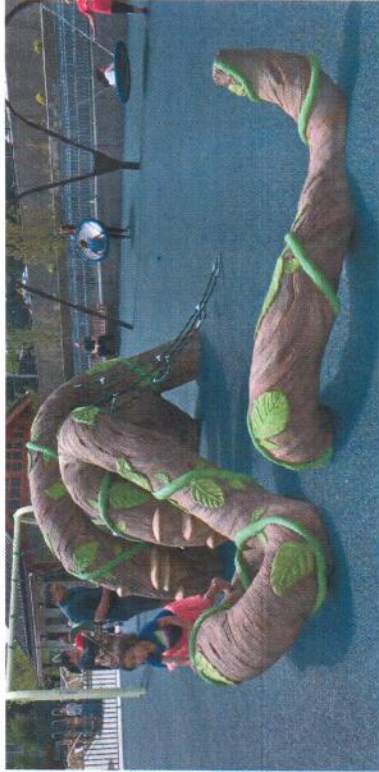

2 Tree of Life Vine

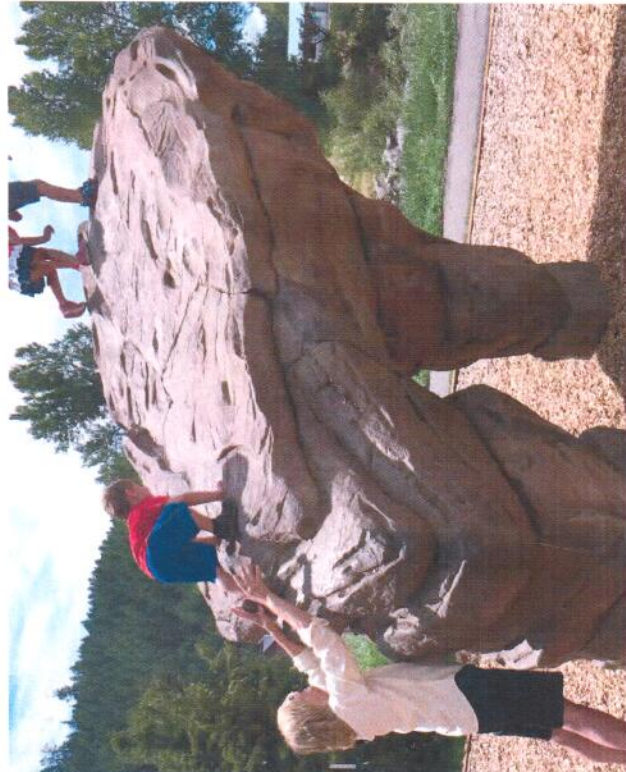

4 Pagosa Boulder_PB006



1 Splitface Balance

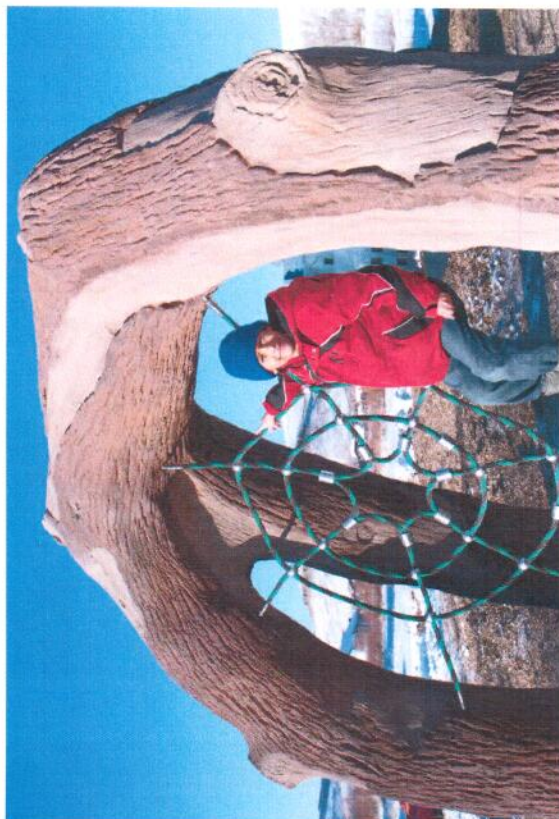

3 Web Climber_AP001

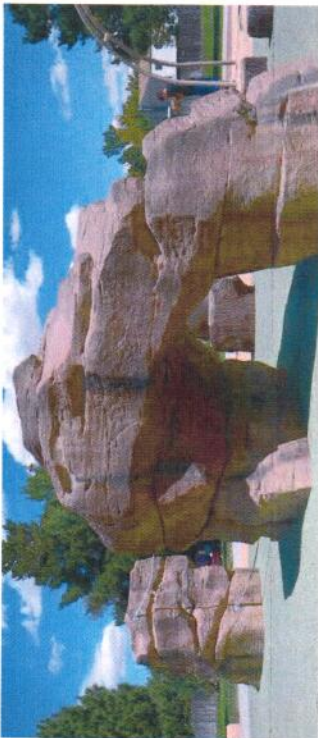

1 Rocks and Rope Combo



2 Moab Arch_CB017



3 Stepping Forms_SF002



4 Palisades Boulder_CB001



5 Erosion Boulder_CB004

All IDS projects are designed to meet or exceed ASTM 1487.

Not all equipment may be appropriate for all children.

Supervision is required.

ASTM compliant safety surfacing is required under and around all play equipment.

The Americans with Disabilities Act (ADA) may require your play area to be accessible, please consult with an ADA professional to ensure compliance.

Date

2/2/2018

Drawing title

Design Reference

Sheet #

A.01.7

All IDS projects are designed to meet or exceed ASTM 1487. Not all equipment may be appropriate for all children. Supervision is required. ASTM compliant safety surfacing is required under and around all play equipment. The Americans with Disabilities Act (ADA) may require your play area to be accessible, please consult with an ADA professional to ensure compliance.

Date	2/2/2018
Drawing Title	Layout V1
Sheet #	A.01.5

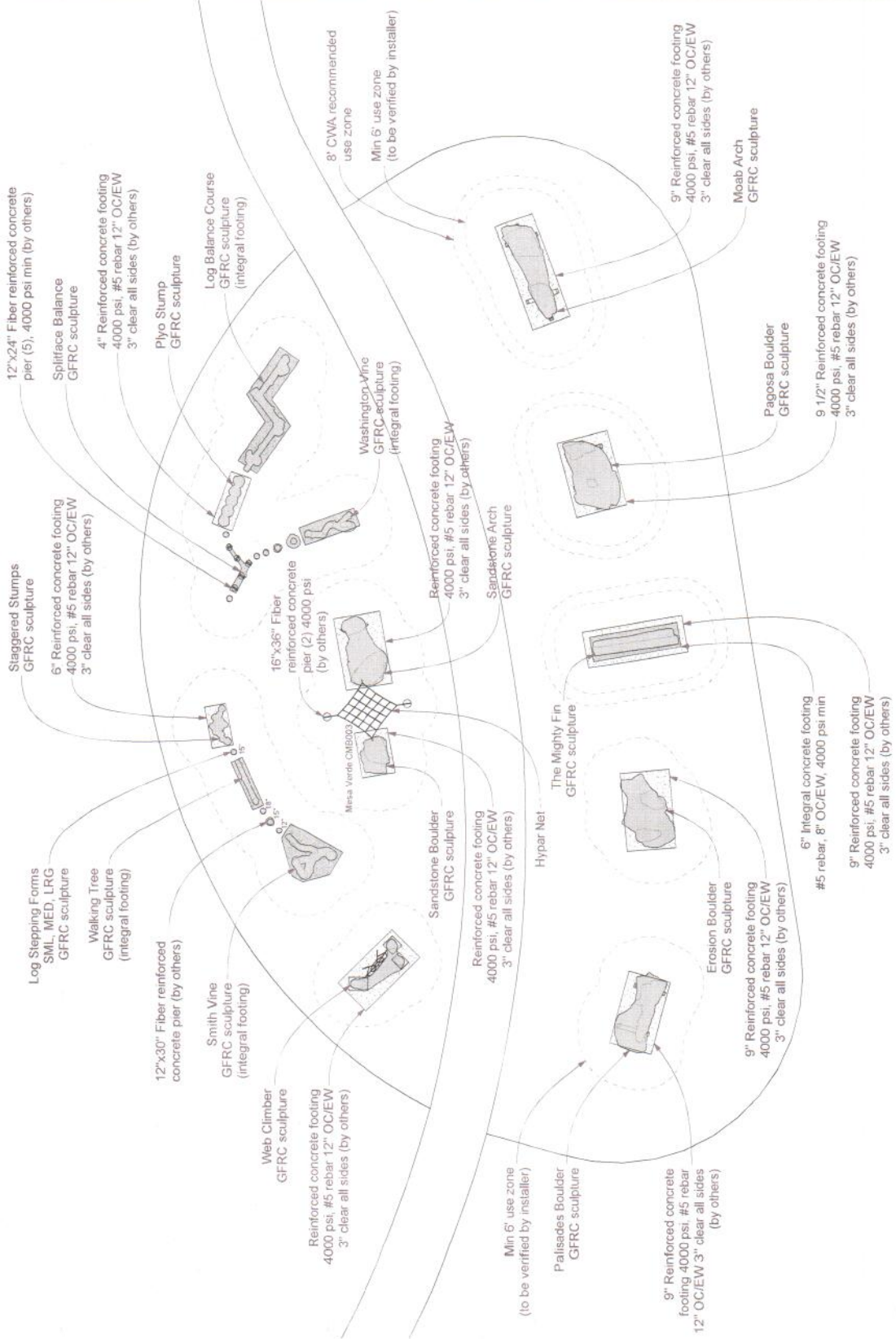

North Liberty Parks & Recreation Committee Meeting

Thursday, January 4, 2018

Board Members Present: Matthew Eckhardt, Jami Maxson, Scott Stahmer, Raquishia Harrington, Jeff Kellbach, Troy Carter
Others Present: Shelly Simpson, Guy Goldsmith, Brian Motley, Tim Hamer
Meeting called to order: 7:00 pm

NEW BUSINESS:

1. **Approve minutes:** Minutes from December 7 meeting approved.
2. **Fees/Membership discussion:** Updated proposals reviewed. Options of daily fees of \$4/\$3 for children and ages 60+ (options of \$5/4 for non-residents). Other package proposals unchanged, except facility track memberships of \$5 resident /\$6 non-resident. Input from board liking ID cards for tracking, still some concern re track fees as obstacle to draw people to the Rec Center. Could recoup some cost for cleaning and resurfacing of track. Problems recognized re enforcing facility pass users with others utilizing community center, possibility of hand stamps to ID those already checked in with pass. Consideration of numbers of pass holders for different packages, fairly large percentage of non-residents purchasing and those package prices greatly decreased.
3. **Aquatics Plan update:** Shelly and Dean Wheatley have been directed to review and recommend final draft, will utilize Dean's input from working on parks plan with Guy. Prioritizing boards A through E recommendations, hoping to do outdoor pool changes FY 2019, but parking changes at a dead end, need to find other options to address parking issue. Staff is continuing to gather surveys re community recreation needs.
4. **Ice Skating update:** Dec 27 started rentals, even with cold weather 21 families have rented skates. Able to readily repair damage after vandalism. Consideration of security camera, could also monitor usage and need for lights.
5. **Winter Trail Maintenance:** Clear trails anytime there is considerable snow. Troy expressed gratitude that this is done. Guy often sees bikers or runners even quite early when he is clearing trails, there is considerable community use.
6. **Building and Grounds Report:** Busy with building maintenance, snow removal, working on equipment maintenance, working on ice rink. Sent in Tree City USA application. Playground for Centennial Park ordered.
7. **Winter/Spring Facility Usage:** Demand high with New Year's resolutions, freezing temps, new programs.
8. **Upcoming events:** Beat the Bitter February 2&3

OLD BUSINESS:

1. **Recreation Monthly Report:** Some breaks in programming with the holidays. Thanks to North Liberty Lions and Good Shepherd Lutheran Church for efforts at Santa Breakfast.

CONCLUSION:

1. **Next Meeting** Thursday February 1, 2018 at 7:00PM
Location: City Council Chambers at 1 Quail Creek Circle
 2. Adjourned at 8:22 pm
- Minutes submitted by Jami Maxson



To: City Council
Park & Recreation Board
City Administration
From: Shelly Simpson, Recreation Director
Re: Recreation Fee Increase Proposal

I am recommending this proposal based on a number of things. Our current facility is approaching 21 years of age; Phase I opened to public in March 1997. Facility fees and package descriptions may have changed but no significant price changes have occurred since 2004 when pool addition opened. Usage and demand has continued to increase with population growth and we have both residents and non-residents using the facility. An aging facility with constant use continues to significantly impact our building maintenance and cleaning expenses. I have also seen a change in the percentages of taxes and user fees covering operational costs both in recreation and pool budgets. If the desire is to keep tax rates low, than user fees need to be increased.

I would like to begin with facility daily fees. We currently charge various pricing for daily use based on what area of the facility one is using. Daily fees are charged for use of the weight & exercise area, pools, and gymnasium for designated play such as pickleball and full court basketball. The range is from \$1 to \$4. We would like to simplify operations and propose one rate for all drop in use. The proposed rate:

	Residents	Non-residents	
Adults (age 19-59):	\$4.00	\$5.00	(25%^)
Children (age 3-18) / Seniors (age 60+)	\$3.00	\$4.00	(33%^)

We currently do not charge for track use, but this is a heavily used part of the facility and during the winter months needs constant upkeep by custodial staff. In 2015, a \$69,740 expense was incurred to resurface the track.

Higher drop-in fees are being proposed to push & promote the purchase of memberships as the better value. I believe we really accommodate the community in providing very reasonable priced memberships that are unique to the individual based on what area of the facility is of interest, number of family members, and if they want to pay monthly or annual fees. Membership fees are the better value as they are based on a \$2 daily fee times 3 days a week times 4 weeks, approximately \$24/\$25 per month versus the \$4 proposed daily fee. Promoting memberships will also assist in identification of users and sense of ownership when using the facility. Our membership types are:

Black & Gold: Access to weight & exercise area, track, pools, open gyms, etc (all inclusive)

Gold: Access to weight & exercise area and track only.

Silver: Access to pools only.

Facility/Track: Access to track and/or open gym activities.

Proposed membership rates follow on next page.

		Black & Gold		Gold		Silver		Facility / Track	
		Resident	Non-res	Resident	Non-res	Resident	Non-res	Resident	Non-res
Monthly	Individual	\$ 45.00	\$ 56.00	\$ 25.00	\$ 32.00	\$ 25.00	\$ 32.00	\$ 10.00	\$ 13.00
	Child-Student- Military-Senior	\$ 36.00	\$ 45.00	\$ 20.00	\$ 25.00	\$ 20.00	\$ 25.00	\$ 5.00	\$ 6.00
	Couple	\$ 85.00	\$106.00	\$ 45.00	\$ 56.00	\$ 45.00	\$ 56.00	\$ 15.00	\$ 19.00
	Family	\$152.00	\$190.00	\$ 80.00	\$100.00	\$ 80.00	\$100.00	\$ 20.00	\$ 25.00
	Addtl member	\$ 8.00	\$ 10.00	\$ 8.00	\$ 10.00	\$ 8.00	\$ 10.00	\$ 3.00	\$ 4.00
Annual	Individual	\$270.00	\$338.00	\$150.00	\$188.00	\$150.00	\$188.00	\$ 60.00	\$ 75.00
	Child-Student- Military-Seniors	\$216.00	\$270.00	\$120.00	\$150.00	\$120.00	\$150.00	\$ 30.00	\$ 38.00
	Couple	\$510.00	\$638.00	\$270.00	\$338.00	\$270.00	\$338.00	\$ 90.00	\$113.00
	Family	\$912.00	\$1,140.00	\$480.00	\$600.00	\$480.00	\$600.00	\$120.00	\$150.00
	Addtl member	\$ 48.00	\$ 60.00	\$ 48.00	\$ 60.00	\$ 48.00	\$ 60.00	\$ 18.00	\$ 23.00

As you can see we propose in offering packages on a monthly or annual basis from date of purchase both at a resident and non-resident rate. Within the packages, we would be promoting annual rates as your best priced option. Black & Gold packages the most economical if using all areas of the facility. The Gold and Silver packages priced the same yet respective to what area of facility specifically used. The biggest change is adding the Facility/Track package for those that only use the facility for track and open gym activities. Open gym activity users are currently paying drop-in fees or obtaining monthly passes. Resident track users are not being charged while non-residents are charged a \$5 annual fee to date.

The track and gymnasiums are large areas of the facility that incur many expenses such as custodial hours, mechanical devices and utility expenses to which staff would like to place back onto all users at a very minimal fee. For example, a resident can use the track/gymnasiums at the proposed \$10 monthly fee calculates to \$.32 per day. A resident child/senior citizen is proposed at \$5 monthly fee which calculates to \$.16 per day. Similar to other packages the annual rates are again best priced options. Child/Senior Citizen at \$30 annual fee calculates to \$.08 per day.

Financial Aid will continue to be provided to those residents that meet the requirements. Income verification is through Hawkeye Area Community Action Program (HACAP) Low Income Energy Assistance Program and cross referenced into chart used by Iowa City School District reduced lunch guidelines to determine percent of fee to be paid. Most applicants fall into paying 15% of regular fee. Financial Aid is applied to Annual memberships only. For example, the lowest charge with financial assistance for a resident child calculates to \$4.50 per year; for resident family calculates to \$18 per year.

The facility remains community service oriented in providing numerous programs/activities at very reasonable prices, free community special events, and the Kids Campsite area at no cost. We are proposing to implement this proposed fee change to begin May 1, 2018. Thank you for your consideration.

Shelly Simpson, Recreation Director

**To: Park & Recreation Commission Board Members
Mayor, City Council and City Administrator**
From: Shelly Simpson, Recreation Director
Date: February 27, 2018
Re: Monthly Report – February 2018

Program Summaries – February

Swim Lessons:

Parent Tot: 24 participants
Tadpoles: 15 participants
Level 1: 15 + 30 (Sat) = 45 participants
Level 2: 15 + 15 (Sat) = 30 participants
Level 3: 15 participants
Level 4: 16 participants
Level 5: 11 participants
Level 6: 15 participants
Private – T: 27 participants
TH: 26 participants
Adult: 1 participant
Totaling; 225 participants this month

Ashley has done a great job in trying to accommodate demand for swim lessons. Last Fall with school bell changes we had to cancel lessons at 4:00pm. Ashley began offering Sat. swim lessons for Level 1 & 2 which were appreciated.

Pool Programs:

Early Bird Aqua Aerobics: Class resumes in March
Easy Does It: 6 participants, plus drop-ins.
Water Resistance AM: 4 participants, plus drop-ins.
Aqua Boot Camp: 1 participant, plus drop-ins.
Arthritis Foundation Aqua: 25 participants, plus drop-ins.
Noodle Triathlon Workout: Drop-ins only.
Rec Swim Team: Tuesdays; 6:30pm = 12; 7:30pm = 8; totaling 20 participants
Thursdays; 6:30pm = 12; 7:30pm = 5; totaling 17 participants
Stroke Development: 4 participants

Ashley has started a Rec Swim Team program and due to popularity; two time frames are offered. Arthritis Aqua classes remain popular. Stroke Development is a new program as well.

Preschool:

Kids Campsite: This month; 814 participants
Lucky Duck: Back to Tuesdays & Thursdays; this month \$ 56.00 collected
Wiggle Worms: 6 participants
Music & Movement: This session had 10 participants.
Kinder Club: 16 participants, plus walk-ins
Pee Wee Sports: Baseball AM – 14 participants; PM – 35 participants
Motion Madness: This session canceled due to lack of enrollment.
Lil Chefs: This session canceled due to lack of enrollment.
Tippi Toes: Baby Ballet: 2 participants
Toddler & Me: 3 participants
Ballet/Jazz/Tap: No enrollment this session

The Kids Campsite remains a popular area of the community center. Kyle continues to do a great job with our Pee Wee Sports program. Wiggle Worms, Music & Movement, Kinder Club and Tippi Toes (new Spring offerings) are all contract programs using our facility space to offer their classes.

Youth Programs:

Recsters BASP: AM – 15, PM-62, totaling 77 participants
All Day (Feb 28): 7 participants
Parents Night Out (Feb 9): Canceled due to weather

Matt Fielder is the supervisor for our Before & After School, Summer Camp programs. He started offering a new program Parents Night Out which happened to be canceled due to weather this month.

Youth Sports:

NLC Basketball: Grades 1-2: NL - Boys 112; Girls 80; CV – Boys 90; Girls 40 participants
Grades 3-4: NL - Boys 46; Girls 52; CV – Boys 70; Girls 40 participants
Grades 5-6: NL - Boys 41; Girls 29; CV – Boys 60; Girls 30 participants
Totaling 360 registered through NL, 330 registered through CV

Both Brian & Kyle work on this cooperative program with Coralville. Games are played on Saturdays at all gymnasium sites at Rec Center and schools to accommodate the 690 participants.

Youth Competitive Leagues: Grade 5: Boys -0-; Girls 8 teams
Grade 6: Boys 16; Girls 6 teams
Grade 7: Boys 6; Girls -0- teams
Grade 8: Boys 7; Girls -0- teams
Totaling - 43 teams participating

Brian & Kyle work on this league in which teams sign up as complete team with coach. We are seeing more competitive/traveling teams wanting a place to play sport specific games year-round.

Youth Soccer Clinic (Feb 16): Grade K-2: 11 participants
Grade 3-5: 2 participants

Brian works with Jason Witt with Cedar River Soccer Association to offer soccer clinics and program.

Tae Kwon Do M/TH: 7 participants
Tae Kwon Do T/W: 3 participants

These are contract programs using space as well.

Adult Sports/Programs: (Feb 1-26)

Basketball: Package \$60; Drop-in \$108; totals \$ 168.00
Pickleball: Package \$150; Drop-in \$424; totals \$ 574.00
Volleyball: Package \$ -0-; Drop-in \$58; totals \$ 58.00

Pickleball seems to be growing and growing in popularity.

Adult Basketball: 16 team league
Co-ed Volleyball: B division is a 10 team league

Brian and Kyle supervise our adult leagues.

Adult Fitness:

Cardio Pump: 3 participants, plus drop-ins.
 Cross Training: 2 participants, plus drop-ins.
 Boot Camp: Drop-ins only.
 Lower Body Blast: Drop-ins only.
 Body Blast: 2 participants, plus drop-ins.
 Body Sculpt: 1 participant, plus drop-ins.
 Personal Training: This month totals: Kris = -0-; Allan = -0-; Rachel = -0-

Senior Citizens:

Senior Dining: Feb 2 19 participants
 Feb 9 -0-; canceled due to weather
 Feb 16 16 participants
 Feb 23 17 participants
 Total for month: 52 participants

Special Events:

Beat The Bitter, Feb 2 & 3: This continues to be a great community event, just wish we could have a bit of snow on the ground. Assisted with Kids playground/obstacles both days.

Boy Scout Chili Supper: Annual event held in gymnasium at Community Center. Approximately 450-500 in attendance.

Rough Riders Hockey: NL Night at CR Roughriders was held Feb. 24

Jr High Ski Trip: 87 NCJH students signed up for this trip. Matt Meseck and other staff take this annual trip to Sundown.

Family Open Gym: Free, 1st & 3rd Tuesdays, 2nd & 4th Fridays each month
 Seeing a return of families coming to shoot hoops.

Regular Open Gym: Free, 2nd & 4th Tuesdays, 1st & 3rd Fridays each month
 Regular shooting baskets times in gymnasium.

ActiveNet Totals: Gross Income (Feb 1-26) = \$ 38,957.00

Residency Breakdown - POS: (Feb 1-26)

	Resident	Nonresident	Total	Previous Month
Track	120	37	157	258
Daily Weight	920	106	1,026	1,298
Senior DW	165	32	197	207
Sub Total	1,085	138	1,223	1,505

	Adult	Youth/Seniors	Total	Previous Month
Pool Daily Fees	379	657	1,036	968

Net Revenue Report By Account Name

GL Account: Aquatic Programs/ Classes, Baseball/ Softball, Before/After School, Classes/Programs, Conf. Center Rental, Daily Pool Fees, Donations/ Misc., Field Rental, Gerdin CC Rental, Gym Rentals, League Fees, Membership, Park/ Special Event Fees, Pool Concessions, Pool Passes, Pool Programs, Pool Rentals, Rec. Rentals, Swim Lessons, Weight Fees
 Transaction Date/Time: From Feb 1, 2018 through Feb 26, 2018
 Revenue Site: North Liberty Recreation Department

Account Name	Account #	Regular Sales +	POS Sales +	Total Deposits -	Total Discount =	Total Income	Total Refs/ Credits/ - Paid-Outs -	Total Expense =	Net Revenue	Other Information			
										Unpaid Amounts	Paid Amounts	Deferred Revenue	POS QTY
Aquatic Programs/ Classes	Aquatic Programs/ Classes	\$2,034.50	\$465.00	\$0.00	\$0.00	\$2,499.50	(\$245.50)	\$0.00	\$2,254.00	\$0.00	\$2,254.00	\$0.00	161
Before/After School	Before/After School	\$13,700.00	\$0.00	\$0.00	(\$630.00)	\$13,070.00	\$0.00	\$0.00	\$13,070.00	\$0.00	\$13,070.00	\$0.00	
Classes/Programs	Classes/Programs	\$6,609.00	\$1,237.00	\$0.00	\$0.00	\$7,846.00	(\$278.75)	\$0.00	\$7,567.25	\$0.00	\$7,567.25	\$0.00	442
Daily Pool Fees	Daily Pool Fees	\$0.00	\$3,863.00	\$0.00	\$0.00	\$3,863.00	\$0.00	\$0.00	\$3,863.00	\$0.00	\$3,863.00	\$0.00	1220
Pool Passes	Pool Passes	\$4,018.00	\$0.00	\$0.00	\$0.00	\$4,018.00	(\$24.00)	\$0.00	\$3,994.00	\$0.00	\$3,994.00	\$0.00	
Rec. Rentals	Rec. Rentals	\$45.00	\$14.00	\$0.00	\$0.00	\$59.00	\$0.00	\$0.00	\$59.00	\$0.00	\$59.00	\$0.00	28
Swim Lessons	Swim Lessons	\$1,995.00	\$0.00	\$0.00	\$0.00	\$1,995.00	(\$1,315.00)	\$0.00	\$680.00	\$0.00	\$680.00	\$0.00	
Weight Fees	Weight Fees	\$5,046.75	\$2,423.00	\$0.00	\$0.00	\$7,469.75	\$0.00	\$0.00	\$7,469.75	\$0.00	\$7,469.75	\$0.00	1241
Grand Total:		\$33,448.25	\$8,002.00	\$0.00	(\$630.00)	\$40,820.25	(\$1,863.25)	\$0.00	\$38,957.00	\$0.00	\$38,957.00	\$0.00	3092

* Linked account credits

To: Mayor and City Council
Parks and Recreation Commission
City Administrator

From: Guy Goldsmith, Director of Parks, Building and Grounds

Date: March 1, 2018

Re: Monthly Report

We performed building maintenance as needed this month. We refinished all of the Parks Maintenance facility floors.

We continue to pick up park/trail trash receptacles and pet waste stations every week this past month.

We maintained equipment as needed this month. We performed preventative maintenance and repaired winter equipment as time permitted. We continue to prepare for the upcoming growing season by performing preventative maintenance and repairs to ball field maintenance, mowing, trimming and landscaping equipment

We removed snow and ice from City parking lots, sidewalks, trails and Hwy 965 intersections as needed this past month.

We are currently purchasing supplies and ordering plants and trees to prepare for the upcoming season.

The future Centennial Park playground has been delivered to the Parks Maintenance facility. The playground is scheduled for a June 25th - 29th install.

Park Staff assisted with the Beat the Bitter event this past month. It was a great success and a huge thank you goes out to all of our volunteer helpers.

I completed Parks Department Staff performance evaluations and reviews.

We are currently seeking 10 seasonal employees to hire for the upcoming season. We completed online hiring information for Iowa, ISU, Cornell and Kirkwood to name a few. We have two seasonal employees returning from last year.