

# City of North Liberty



## Request for Proposals (RFP) – ADDENDUM 1

For

Centennial Park Event Complex Phase 1

Audiovisual Systems

All Proposal Must Be Submitted To:

Tracey Mulcahey

[tmulcahey@northlibertyiowa.org](mailto:tmulcahey@northlibertyiowa.org)

Issue Date:

August 31, 2023

Deadline for Proposal Submittal:

September 7, 2023

## Addendum 1

This Addendum forms a part of the bidding and contract documents. This Addendum supersedes and supplements all portions of the Request for Proposal dated August 18, 2023 with which it conflicts. ACKNOWLEDGE RECEIPT OF THIS ADDENDUM IN BIDDER RESPONSE. FAILURE TO DO SO MAY SUBJECT THE BIDDER TO DISQUALIFICATION.

### Item Number:

1. Overall Project Scope
  - a. ADD: Hall Max-Min Height – 26'-24' & Stage Max-Min Height – 30'-27'
  - b. ADD: Track lighting with LED heads is planned for use within Hall. Track is to be installed along the sides of structural trusses to conceal lighting approach within space while providing flexibility to aim, re-position, and add/remove track heads within space based on usage of space. Intent is that lighting does not extend beyond bottom of structural trusses in space. Lighting will be dimmable with select zone control for on/off switching of different areas of space. Lighting info is for reference only; not part of A/V proposal.
  - c. ADD: Preliminary Description of south elevation of Hall: Overall approximate length of the south wall is 76'. Centered in the wall is 70'-8" length of full height glazing. Centered in the glazing is a 40' length wall that is 13' tall. Adjustments could be incorporated in collaboration with A/V Team.
2. Project Objectives:
  - a. Item 3: The intent for the south and east is to provide options for room setup/front of room. It is intended that there is duplicate content between the two.
  - b. Delete Item #7
    - i. ~~7. Connection to allow for content management from office computer to all screens.~~
  - c. Alternate 2 – Audio accommodations exclude accommodations for performance with audience on the lawn. These will be accommodated via a system provided by a vendor and power provisions for this will be provided outside of this RFP. Audio for stage is limited to accommodations for events such as a reception or seated event where audio for a presentation or house music would be needed.
  - d. ADD: There will be staff at this location (1-2). There will be an orientation and handoff to renters. System operation will be 50/50; City events will be by staff and rentals will be by renters. User friendly, intuitive interface is critical.
  - e. Projection screen and projector versus monitors is open to bidders. Bidders can provide add alternate for higher cost scenario as Alternate #3.
3. Proposal Response Requirements
  - a. 8.b. Clarification: Two alternates are specified.
  - b. Bidder to includes in their bid all necessary mounts, brackets, etc. for screen and equipment installation. Owner will provide blocking and other provisions as required.
4. Attachments
  1. A131 First Floor Reflected Ceiling Plan dated 8/12/23.

CEILING PLAN NOTES

1. NOTIFY ARCHITECT OF INADEQUATE CLEARANCES FOR CEILING LAYOUT PRIOR TO COMMENCING WORK.
2. LOCATIONS OF LIGHT FIXTURES, DIFFUSERS, ETC. SHALL BE AS SHOWN ON THE ARCHITECTURAL REFLECTED CEILING PLANS AND DETAILS. NOTIFY ARCHITECT OF ANY CONFLICTS PRIOR TO PROCEEDING WITH CONSTRUCTION. REFER TO DRAWINGS AND SPECIFICATIONS OF ALL TRADES FOR SYSTEM DESIGN AND ADDITIONAL INFORMATION.
3. COORDINATE WITH ALL TRADES TO CONFIRM THEIR WORK CAN BE INSTALLED TO ACHIEVE CEILING HEIGHTS AS SHOWN. TRADE PRIORITY SHALL BE AS FOLLOWS UNLESS DIRECTED OTHERWISE BY THE ARCHITECT:
  - ELECTRICAL LIGHTING FIXTURES
  - MECHANICAL GRILLES AND DIFFUSERS
  - MECHANICAL DUCTWORK
  - ELECTRICAL CONDUIT
  - PIPING SYSTEMS
4. COORDINATE WITH ALL TRADES TO CONFIRM THE LOCATION OF ACCESS PANELS WITH ASSOCIATED INSTALLED EQUIPMENT. INFORM ARCHITECT OF PROPOSED LOCATIONS PRIOR TO INSTALLATION AND CONSTRUCTION OF NEW WORK.
5. ALL CEILING LIGHT FIXTURES TO BE CENTERED ON CEILING PANELS UNLESS SHOWN OTHERWISE. GRID OR PANEL IS TO BE CENTERED IN ROOM UNLESS SHOWN AND DIMENSIONED OTHERWISE.
6. ALL CEILING PANELS TO BE [CP-1] UNLESS NOTED OTHERWISE.
7. SOFFITS TO RECEIVE [DESIGNATE FINISH] ON VERTICAL AND HORIZONTAL SURFACES [UNLESS NOTED OTHERWISE].

KEYNOTES

KEY	NOTE
-----	------

CEILING PLAN SYMBOLS LEGEND

	CEILING MATERIAL DESIGNATION
	CEILING HEIGHT
	ACCENT FINISH DESIGNATION
	GYPSUM BOARD CEILING/ SOFFIT, SEE MATERIAL FINISH LEGEND
	ACOUSTICAL CEILING PANEL SYSTEM, SEE MATERIAL FINISH LEGEND
	SURFACE LIGHT
	RECESSED LIGHT
	SURFACE LIGHT
	SUSPENDED OR PENDANT LIGHT
	RECESSED LIGHT
	STRIP LIGHT
	COVE LIGHT
	EXIT LIGHT
	ACCESS PANEL
	RETURN AIR GRILLE
	SUPPLY AIR GRILLE
	EXHAUST AIR GRILLE
	SPEAKER
	SMOKE DETECTOR

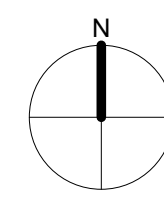
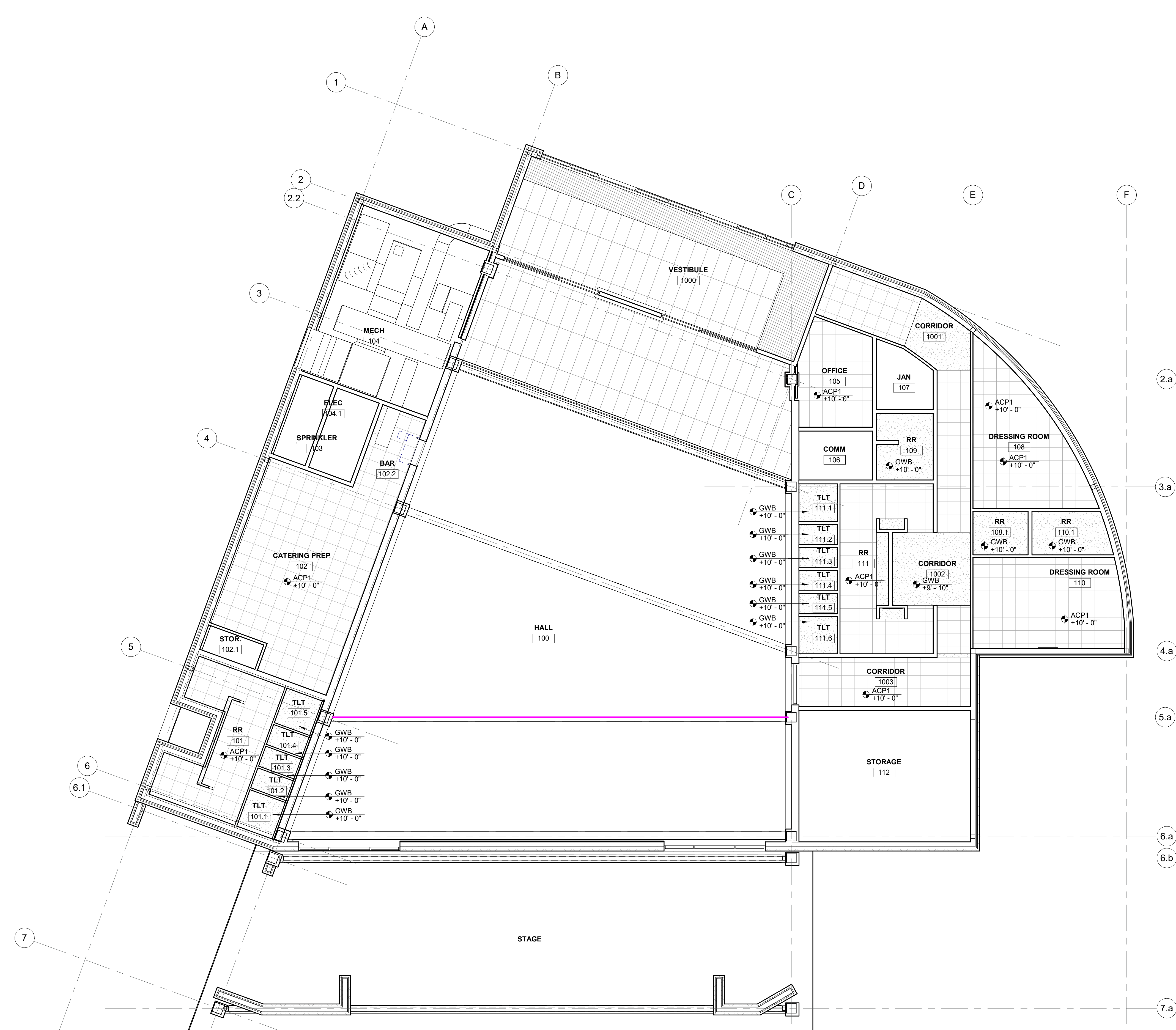

A6 FIRST FLOOR REFLECTED CEILING PLAN  
1/8" = 1'-0" 0" 12"